

Proposed Project at J.L. No-42, Mahalla-Keshabganj, Holding No-641, Ward No-01, under Burdwan Municipality, District-Purba Bardhaman, Pin-713101

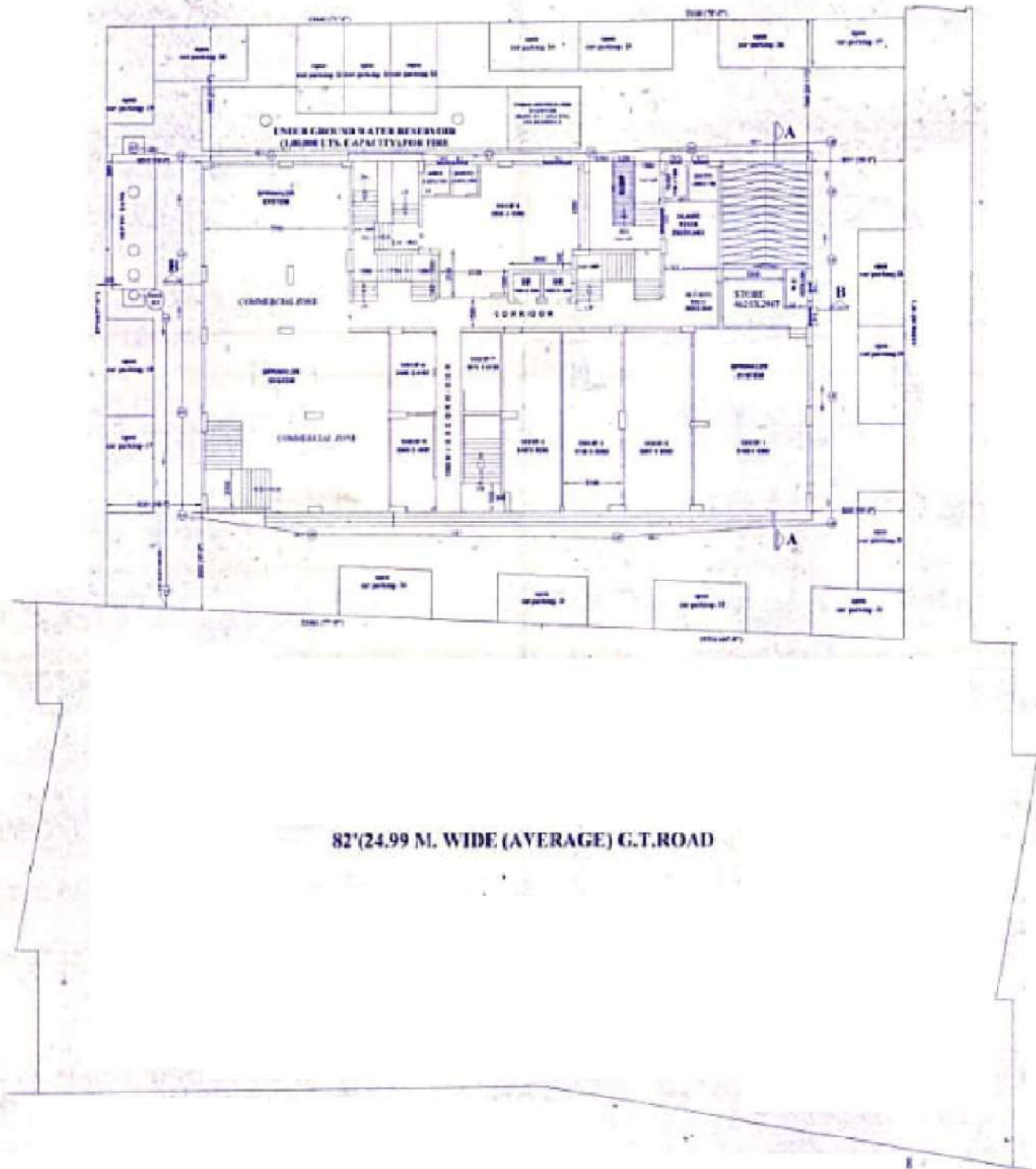

LATITUDE : 23.250739
LONGITUDE : 87.836734

MAA MANASA ENTERPRISE
Bhaskar Ray.
PARTNER

SIGNATURE OF OWNER